

# ISSUED FOR BID

FOR

# SOUTHWEST TRANSIT PLAZA

CHANHASSEN, MN

PREPARED FOR:

**SOUTHWEST TRANSIT**

14405 WEST 62ND ST

EDEN PRAIRIE, MN 55346

CONTACT: JON CHRISTENSON

PHONE: 952-974-3130

EMAIL: JCHRISTENSON@SWTRANSIT.ORG

PREPARED BY:

**Westwood**

Phone (952) 937-5150 12701 Whitewater Drive, Suite #300  
 Fax (952) 937-5822 Minnetonka, MN 55343  
 Toll Free (888) 937-5150 westwoodps.com

Westwood Professional Services, Inc.

PROJECT NUMBER: 0044293.00

CONTACT: JEFF WESTENDORF



Vicinity Map  
(NOT TO SCALE)

**SHEET INDEX**

Sheet List Table	
SHEET NUMBER	SHEET TITLE
C001	COVER
C100	EXISTING CONDITIONS & REMOVALS PLAN
C200	SITE PLAN
C300	GRADING & EROSION CONTROL PLAN
C400	DETAILS
L100	LANDSCAPE PLAN

NO.	DATE	REVISION	SHEETS
	03/03/25	PLAZA REDESIGN	
	.	.	
	.	.	
	.	.	
	.	.	
	.	.	
	.	.	
	.	.	
	.	.	

ISSUED FOR BID

FOR

SOUTHWEST TRANSIT PLAZA

CHANHASSEN, MN

INITIAL SUBMITTAL DATE: 06/09/2023

SHEET: C001

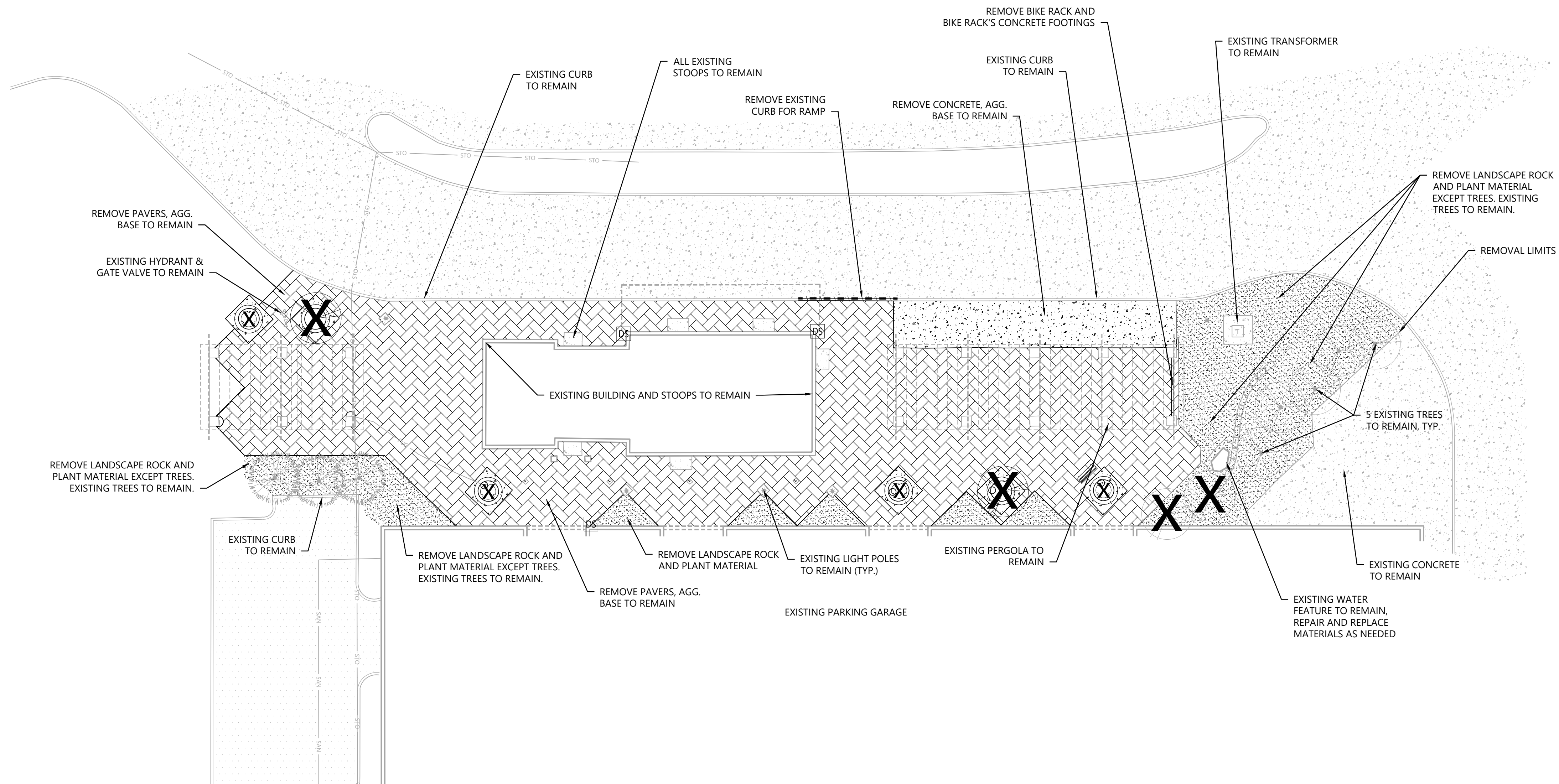

**REMOVAL LEGEND**

EXISTING	PROPOSED	
—	—	PROPERTY LINE
—	—	SAW CUT PAVEMENT
—	—	CURB & GUTTER
—	—	SANITARY SEWER
—	—	WATER MAIN
—	—	HYDRANT
—	—	STORM SEWER
—	—	GAS
—	—	UNDERGROUND ELECTRIC
—	—	OVERHEAD ELECTRIC
—	—	UNDERGROUND TELEPHONE
—	—	OVERHEAD TELEPHONE
—	—	TELEPHONE FIBER OPTIC
—	—	CABLE TELEVISION
—	—	RETAINING WALL
—	—	FENCE
—	—	CONCRETE
—	—	BITUMINOUS
—	—	BUILDING
—	—	TREE
—	—	CONCRETE PLANTER
—	—	LIGHT POLE
—	—	TRAFFIC SIGN
—	—	CONSTRUCTION BARRICADE
—	—	SOIL BORING LOCATION
—	—	TREE LINE

**REMOVAL NOTES**

1. LOCATIONS AND ELEVATIONS OF EXISTING TOPOGRAPHY AND UTILITIES AS SHOWN ON THIS PLAN ARE APPROXIMATE. CONTRACTOR SHALL FIELD VERIFY SITE CONDITIONS AND UTILITY LOCATIONS PRIOR TO EXCAVATION/CONSTRUCTION. THE ENGINEER SHALL BE NOTIFIED IMMEDIATELY IF ANY DISCREPANCIES ARE FOUND.
2. CONTRACTOR SHALL COORDINATE LIMITS OF REMOVALS WITH PROPOSED IMPROVEMENTS AND FIELD VERIFY CONDITION OF EXISTING APPURTENANCES TO REMAIN. CONTRACTOR SHALL BE RESPONSIBLE FOR PROTECTING OR REPLACING MISCELLANEOUS ITEMS (SUCH AS FENCES, SIGNS, IRRIGATION HEADS, ETC.) THAT MAY BE DAMAGED BY CONSTRUCTION.
3. CONTRACTOR SHALL PLACE ALL NECESSARY EROSION CONTROL MEASURES REQUIRED TO MAINTAIN SITE STABILITY PRIOR TO EXECUTING ANY SITE REMOVALS.
4. CONTRACTOR SHALL BE RESPONSIBLE FOR COORDINATION WITH UTILITY PROVIDERS FOR REMOVAL AND/OR RELOCATION OF EXISTING UTILITIES AFFECTED BY SITE DEVELOPMENT. ALL PERMITS, APPLICATIONS AND FEES ARE THE RESPONSIBILITY OF THE CONTRACTOR.

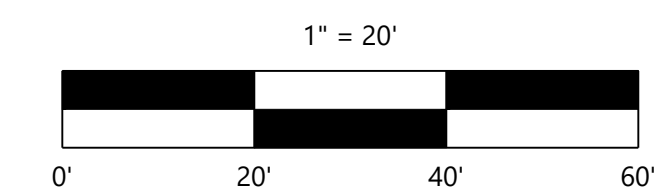

ISSUED FOR BID

DESIGNED:	
CHECKED:	
DRAWN:	
HORIZONTAL SCALE:	20'
VERTICAL SCALE:	4' OF 2'

PREPARED FOR:  
**SOUTHWEST TRANSIT**  
14405 WEST 62ND ST  
EDEN PRAIRIE, MN 55346

I HEREBY CERTIFY THAT THIS PLAN WAS PREPARED BY ME OR UNDER MY CLOSE PERSONAL SUPERVISION AND THAT I AM A DULY LICENSED PROFESSIONAL ENGINEER UNDER THE LAWS OF THE STATE OF MINNESOTA.  
**GRETCHEN SCHROEDER**  
03/03/2025, LICENSE NO. 43016

**SOUTHWEST TRANSIT PLAZA**  
CHANHASSEN, MN

**Westwood**  
12701 Winnetka Drive, Suite #300  
Minnetonka, MN 55343  
westwoodps.com  
Phone: (888) 937-5150  
Fax: (888) 937-5150  
Toll Free: (888) 937-5150  
Westwood Professional Services, Inc.

**EXISTING CONDITIONS & REMOVALS PLAN**

SHEET NUMBER:

**C100**

DATE: 03/03/2025

PROJECT NUMBER: 0044293.00

SOUTHWEST TRANSIT PLAZA



**SITE LEGEND**

EXISTING	PROPOSED	
		PROPERTY LINE
		LOT LINE
		SETBACK LINE
		EASEMENT LINE
		CURB AND GUTTER
		TIP-OUT CURB AND GUTTER
		POND NORMAL WATER LEVEL
		RETAINING WALL
		FENCE
		CONCRETE PAVEMENT
		CONCRETE SIDEWALK
		HEAVY DUTY CONCRETE
		NUMBER OF PARKING STALLS
		TRANSFORMER
		SITE LIGHTING
		TRAFFIC SIGN
		POWER POLE
		BOLLARD / POST

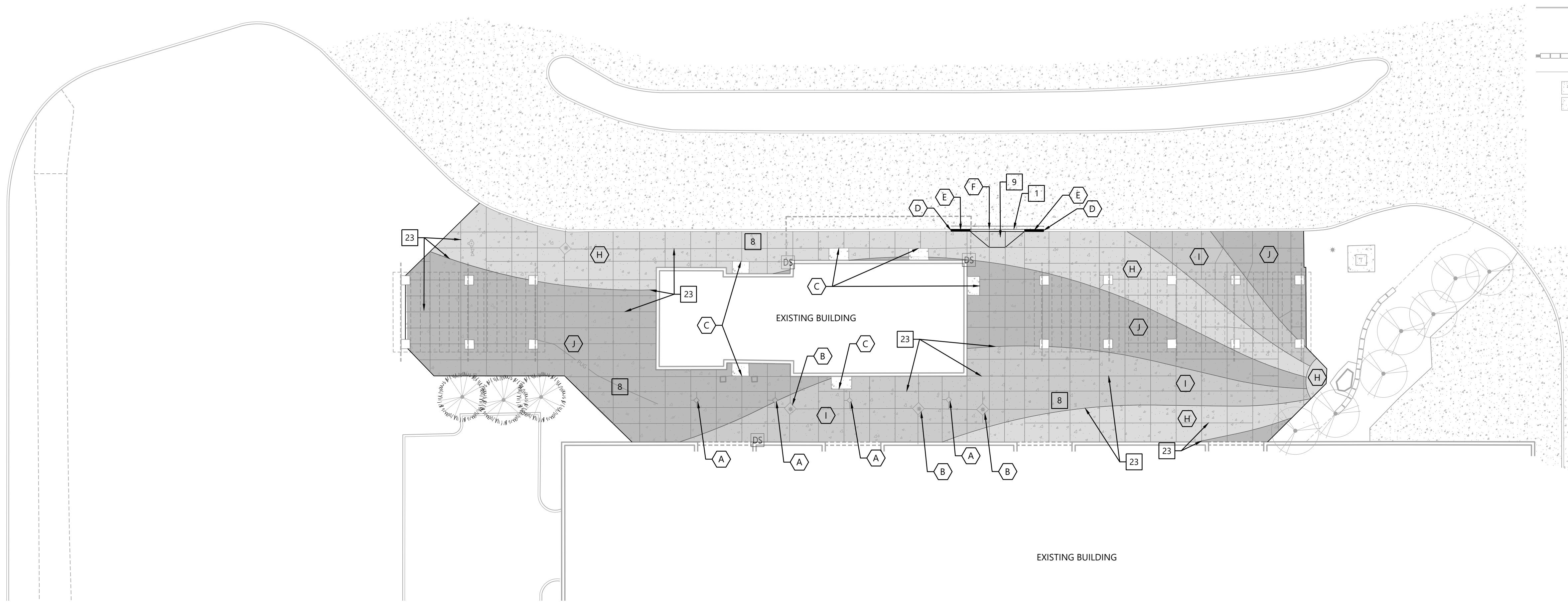

**GENERAL SITE NOTES**

- BACKGROUND INFORMATION FOR THIS PROJECT PROVIDED BY WESTWOOD PROFESSIONAL SERVICES, MINNETONKA, MN, 05/15/2023.
- LOCATIONS AND ELEVATIONS OF EXISTING TOPOGRAPHY AND UTILITIES AS SHOWN ON THIS PLAN ARE APPROXIMATE. CONTRACTOR SHALL FIELD VERIFY SITE CONDITIONS AND UTILITY LOCATIONS PRIOR TO EXCAVATION/CONSTRUCTION. IF ANY DISCREPANCIES ARE FOUND, THE ENGINEER SHOULD BE NOTIFIED IMMEDIATELY.
- REFER TO BOUNDARY SURVEY FOR LOT BEARINGS, DIMENSIONS AND AREAS.
- ALL DIMENSIONS ARE TO FACE OF CURB OR EXTERIOR FACE OF BUILDING UNLESS OTHERWISE NOTED.
- THE CONTRACTOR SHALL BE RESPONSIBLE FOR PROVIDING AND MAINTAINING TRAFFIC CONTROL DEVICES SUCH AS BARRICADES, WARNING SIGNS, DIRECTIONAL SIGNS, FLAGGERS AND LIGHTS TO CONTROL THE MOVEMENT OF TRAFFIC WHERE NECESSARY. PLACEMENT OF THESE DEVICES SHALL BE APPROVED BY THE CITY AND ENGINEER PRIOR TO PLACEMENT. TRAFFIC CONTROL DEVICES SHALL CONFORM TO APPROPRIATE MNDOT STANDARDS.
- BITUMINOUS PAVEMENT AND CONCRETE SECTIONS TO BE IN ACCORDANCE WITH THE RECOMMENDATIONS OF THE GEOTECHNICAL ENGINEER.
- CONTRACTOR SHALL MAINTAIN FULL ACCESS TO ADJACENT PROPERTIES DURING CONSTRUCTION AND TAKE ALL PRECAUTIONS NECESSARY TO AVOID PROPERTY DAMAGE TO ADJACENT PROPERTIES.

**1 SITE DETAILS (SI-0XX)**

- 1 B612 CURB AND GUTTER
- 8 CONCRETE SIDEWALK
- 9 PUBLIC CURB RAMP
- 23 CONSTRUCTION JOINT

**A SITE KEYNOTES**

- A MATCH CONCRETE TO EXISTING AREA DRAIN
- B MATCH CONCRETE TO EXISTING LIGHT POLE (TYP.)
- C MATCH CONCRETE TO EXISTING STOOP
- D MATCH EXISTING CURB
- E TRANSITION CURB
- F FLUSH CURB
- H STAINED CONCRETE (COLOR 1)\*\*
- I NON STAINED CONCRETE
- J STAINED CONCRETE (COLOR 2)\*\*

\*\* COLOR STAIN TO BE REVIVE EXTERIOR STAIN BY SCOFIELD (A SIKA BRAND) OR APPROVED EQUAL. COLOR SAMPLES OR TEST AREA TO BE PROVIDED TO OWNER FOR APPROVAL BEFORE INSTALLATION. **COLOR 1 TO BE 5183- STONE GRAY. COLOR 2 TO BE A57 PLATINUM GRAY.** INSTALLED PER MANUFACTURERS RECOMMENDATIONS. ONCE STAIN IS FULLY DRY, APPLY A COMPATIBLE SCOFIELD SEALER TO LOCK IN THE COLOR AND PROTECT THE SURFACE. SCOFIELD (A SIKA BRAND) 866.934.5689 <https://usa.sika.com/>

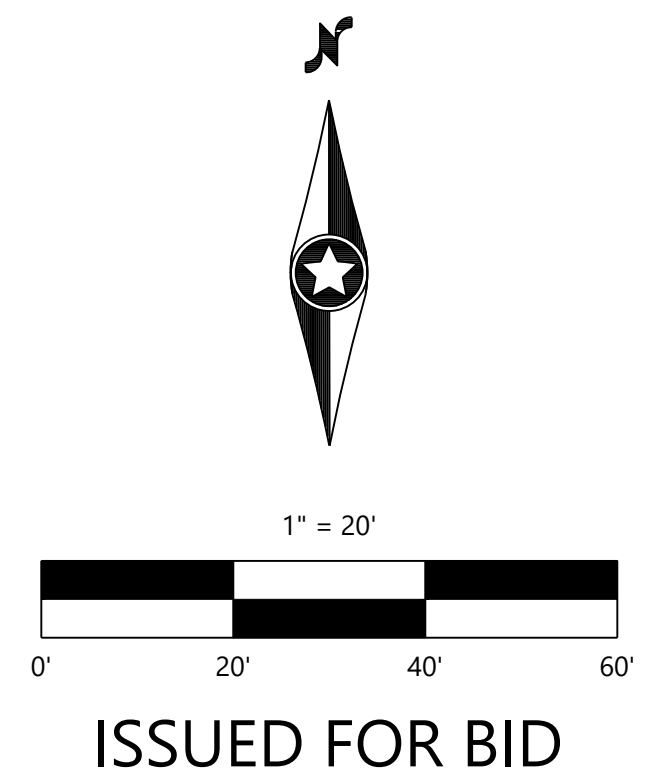

DESIGNED:	
CHECKED:	
DRAWN:	
HORIZONTAL SCALE:	20'
VERTICAL SCALE:	4' OF 2'

PREPARED FOR:  
**SOUTHWEST TRANSIT**  
14405 WEST 62ND ST  
EDEN PRAIRIE, MN 55346

I HEREBY CERTIFY THAT THIS PLAN WAS PREPARED BY ME OR UNDER MY CLOSE PERSONAL SUPERVISION AND THAT I AM A DULY LICENSED PROFESSIONAL ENGINEER UNDER THE LAWS OF THE STATE OF MINNESOTA.  
*Gretchen Schroeder*  
GRETCHEN SCHROEDER  
03/03/2025; LICENSE NO. 43016

**SOUTHWEST TRANSIT PLAZA**  
CHANHASSEN, MN

**Westwood**  
12701 Winnetka Drive, Suite #300  
Minnetonka, MN 55343  
westwoodps.com  
Phone: (952) 837-5150  
Fax: (952) 837-5822  
Toll Free: (888) 937-5150  
Westwood Professional Services, Inc.

**SITE PLAN**

SHEET NUMBER:

**C200**

DATE: 03/03/2025

PROJECT NUMBER: 0044293.00

**GRADING LEGEND**

EXISTING	PROPOSED	
		PROPERTY LINE
		INDEX CONTOUR
		INTERVAL CONTOUR
		CURB AND GUTTER
		STORM SEWER
		WATER MAIN
		SANITARY SEWER
		RETAINING WALL
		DRAIN TILE
		RIDGE LINE
		GRADING LIMITS
		SPOT ELEVATION
		FLOW DIRECTION
		TW=XXXX BW=XXXX
		E.O.F. →
		SILT FENCE/FIBER LOGS
		INLET PROTECTION

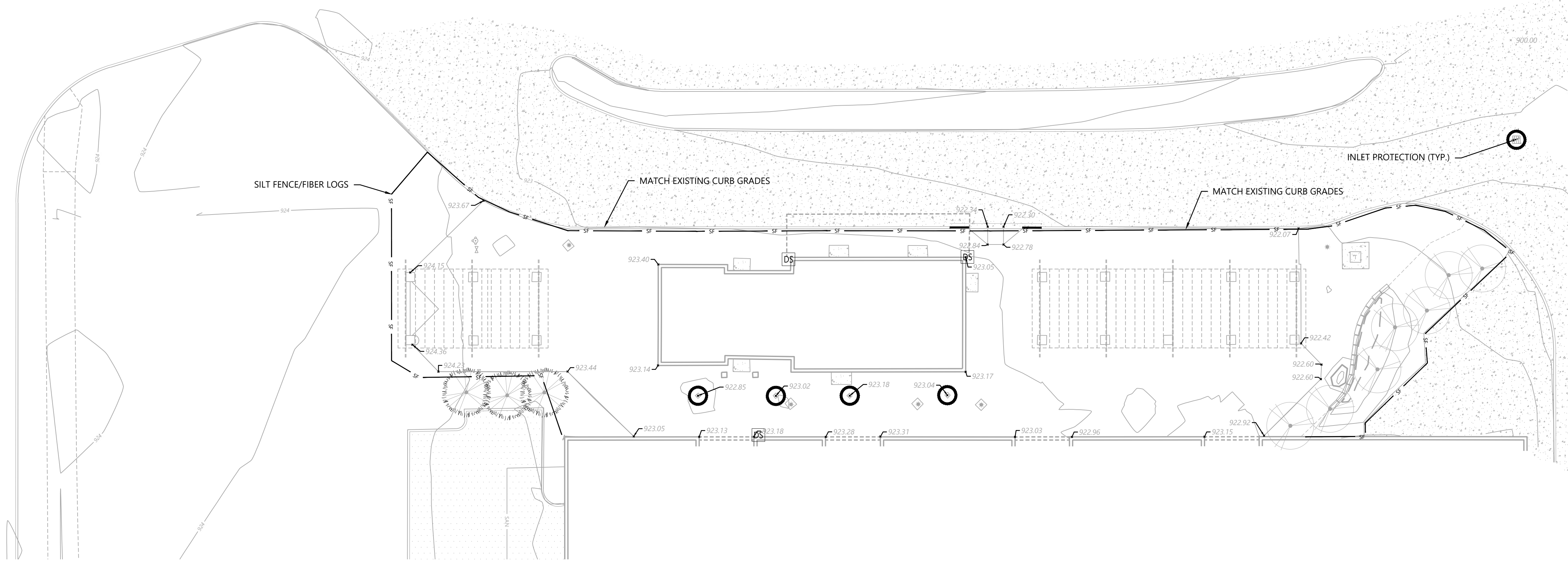

**GRADING NOTES**

- LOCATIONS AND ELEVATIONS OF EXISTING TOPOGRAPHY AND UTILITIES AS SHOWN ON THIS PLAN ARE APPROXIMATE. CONTRACTOR SHALL FIELD VERIFY SITE CONDITIONS AND UTILITY LOCATIONS PRIOR TO EXCAVATION/CONSTRUCTION. THE ENGINEER SHALL BE NOTIFIED IMMEDIATELY IF ANY DISCREPANCIES ARE FOUND.
- ALL DISTURBED UNPAVED AREAS ARE TO RECEIVE SIX INCHES OF TOPSOIL AND SOD OR SEED. THESE AREAS SHALL BE WATERED UNTIL A HEALTHY STAND OF GRASS IS OBTAINED. SEE LANDSCAPE PLAN FOR PLANTING AND TURF ESTABLISHMENT.
- THE CONTRACTOR SHALL BE RESPONSIBLE FOR PROVIDING AND MAINTAINING TRAFFIC CONTROL DEVICES SUCH AS BARRICADES, WARNING SIGNS, DIRECTIONAL SIGNS, FLAGMEN AND LIGHTS TO CONTROL THE MOVEMENT OF TRAFFIC WHERE NECESSARY. PLACEMENT OF THESE DEVICES SHALL BE APPROVED BY THE ENGINEER PRIOR TO PLACEMENT. TRAFFIC CONTROL DEVICES SHALL CONFORM TO APPROPRIATE MNDOT STANDARDS.
- ALL SLOPES SHALL BE GRADED TO 3:1 OR FLATTER, UNLESS OTHERWISE INDICATED ON THIS SHEET.
- CONTRACTOR SHALL UNIFORMLY GRADE AREAS WITHIN LIMITS OF GRADING AND PROVIDE A SMOOTH FINISHED SURFACE WITH UNIFORM SLOPES BETWEEN POINTS WHERE ELEVATIONS ARE SHOWN OR BETWEEN SUCH POINTS AND EXISTING GRADES.
- SPOT ELEVATIONS SHOWN INDICATE FINISHED PAVEMENT ELEVATIONS & GUTTER FLOW LINE UNLESS OTHERWISE NOTED. PROPOSED CONTOURS ARE TO FINISHED SURFACE GRADE.**
- CONTRACTOR SHALL DISPOSE OF ANY EXCESS SOIL MATERIAL THAT EXISTS AFTER THE SITE GRADING AND UTILITY CONSTRUCTION IS COMPLETED. THE CONTRACTOR SHALL DISPOSE OF ALL EXCESS SOIL MATERIAL IN A MANNER ACCEPTABLE TO THE OWNER AND THE REGULATING AGENCIES.
- ALL CONSTRUCTION SHALL CONFORM TO LOCAL, STATE AND FEDERAL RULES INCLUDING THE NATIONAL POLLUTANT DISCHARGE ELIMINATION SYSTEM (NPDES) PERMIT REQUIREMENTS.
- PRIOR TO PLACEMENT OF ANY STRUCTURE OR PAVEMENT, A PROOF ROLL, AT MINIMUM, WILL BE REQUIRED ON THE SUBGRADE. PROOF ROLLING SHALL BE ACCOMPLISHED BY MAKING MINIMUM OF 2 COMPLETE PASSES WITH FULLY-LOADED TANDEM-AXLE DUMP TRUCK, OR APPROVED EQUAL, IN EACH OF 2 PERPENDICULAR DIRECTIONS WHILE UNDER SUPERVISION AND DIRECTION OF THE INDEPENDENT TESTING LABORATORY. AREAS OF FAILURE SHALL BE EXCAVATED AND RE-COMPACTED AS SPECIFIED HEREIN.
- EMBANKMENT MATERIAL PLACED BENEATH BUILDINGS AND STREET OR PARKING AREAS SHALL BE COMPACTED IN ACCORDANCE WITH THE SPECIFIED DENSITY METHOD AS OUTLINED IN MNDOT 2105.3F1 AND THE REQUIREMENTS OF THE GEOTECHNICAL ENGINEER.
- EMBANKMENT MATERIAL NOT PLACED IN THE BUILDING PAD, STREETS OR PARKING AREA, SHALL BE COMPACTED IN ACCORDANCE WITH REQUIREMENTS OF THE ORDINARY COMPACTION METHOD AS OUTLINED IN MNDOT 2105.3F2.

**GENERAL EROSION CONTROL NOTES**

- ALL SILT FENCE AND OTHER EROSION CONTROL FEATURES SHALL BE IN-PLACE PRIOR TO ANY EXCAVATION/CONSTRUCTION AND SHALL BE MAINTAINED UNTIL VIABLE TURF OR GROUND COVER HAS BEEN ESTABLISHED. EXISTING SILT FENCE ON-SITE SHALL BE MAINTAINED AND OR REMOVED AND SHALL BE CONSIDERED INCIDENTAL TO THE GRADING CONTRACT. IT IS OF EXTREME IMPORTANCE TO BE AWARE OF CURRENT FIELD CONDITIONS WITH RESPECT TO EROSION CONTROL. TEMPORARY PONDING, DIKES, HAYBALES, ETC., REQUIRED BY THE CITY SHALL BE INCIDENTAL TO THE GRADING CONTRACT.
- EROSION AND SILTATION CONTROL (ESC): THE CONTRACTOR SHALL ASSUME COMPLETE RESPONSIBILITY FOR CONTROLLING ALL SILTATION AND EROSION OF THE PROJECT AREA. THE CONTRACTOR SHALL USE WHATEVER MEANS NECESSARY TO CONTROL THE EROSION AND SILTATION INCLUDING BUT NOT LIMITED TO: CATCH BASIN INSERTS, CONSTRUCTION ENTRANCES, EROSION CONTROL BLANKET, AND SILT FENCE. ESC SHALL COMMENCE WITH GRADING AND CONTINUE THROUGHOUT THE PROJECT UNTIL ACCEPTANCE OF THE WORK BY THE OWNER. THE CONTRACTOR'S RESPONSIBILITY INCLUDES ALL IMPLEMENTATION AS REQUIRED TO PREVENT EROSION AND THE DEPOSITING OF SILT. THE OWNER MAY DIRECT THE CONTRACTOR'S METHODS AS DEEMED FIT TO PROTECT PROPERTY AND IMPROVEMENTS. ANY DEPOSITION OF SILT OR MUD ON NEW OR EXISTING PAVEMENT OR IN EXISTING STORM SEWERS OR SWALES SHALL BE REMOVED AFTER EACH RAIN EVENT. AFFECTED AREAS SHALL BE CLEANED TO THE SATISFACTION OF THE OWNER. ALL AT THE EXPENSE OF THE CONTRACTOR. ALL TEMPORARY EROSION CONTROL SHALL BE REMOVED BY THE CONTRACTOR AFTER THE TURF IS ESTABLISHED.
- ALL STREETS DISTURBED DURING WORKING HOURS MUST BE CLEANED AT THE END OF EACH WORKING DAY. A CONSTRUCTION ENTRANCE TO THE SITE MUST BE PROVIDED ACCORDING TO DETAILS TO REDUCE TRACKING OF DIRT ONTO PUBLIC STREETS.
- ALL UNPAVED AREAS ALTERED DUE TO CONSTRUCTION ACTIVITIES MUST BE RESTORED WITH SEED AND MULCH, SOD, EROSION CONTROL BLANKET OR BE HARD SURFACE WITHIN 2 WEEKS OF COMPLETION OF CONSTRUCTION.
- THE SITE MUST BE KEPT IN A WELL-DRAINED CONDITION AT ALL TIMES. THE CONTRACTOR SHALL BE RESPONSIBLE FOR TEMPORARY DITCHES, PIPING OR OTHER MEANS REQUIRED TO INSURE PROPER DRAINAGE DURING CONSTRUCTION. LOW POINTS IN ROADWAYS OR BUILDING PADS MUST BE PROVIDED WITH A POSITIVE OUTFLOW.

**LAND DISTURBANCE SUMMARY**

GRADING DISTURBANCE IS LIMITED TO LANDSCAPE REMOVAL/ RECONSTRUCTION AREAS. EXISTING SUBGRADE MAINTAINED IN ALL OTHER AREAS.

TOTAL SITE DISTURBED AREA 4,240 SF

PROJECT IS BELOW 5,000 SF OF DISTURBANCE OR 50 CY OF EARTHWORK THRESHOLD FOR RILEY-PURGATORY-BLUFF CREEK WATERSHED PERMIT.

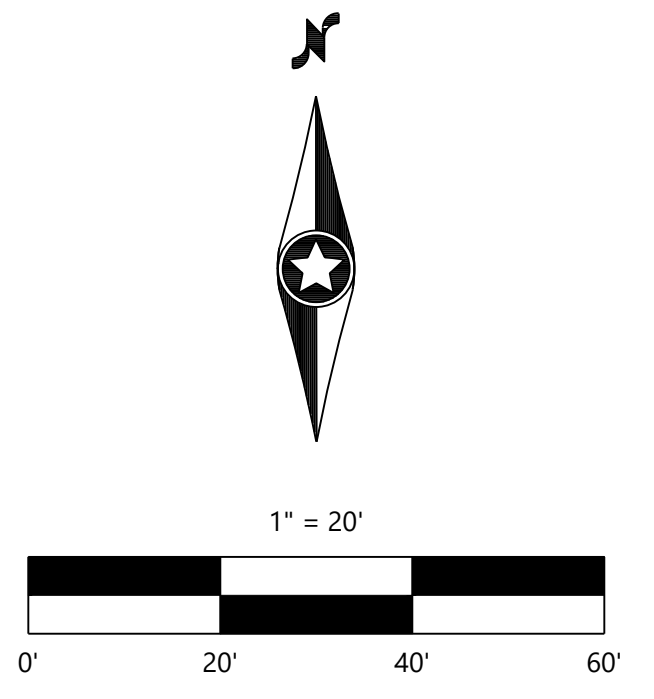

DESIGNED:	
CHECKED:	
DRAWN:	
HORIZONTAL SCALE:	20'
VERTICAL SCALE:	4' OF 2'

PREPARED FOR:  
**SOUTHWEST TRANSIT**  
14405 WEST 62ND ST  
EDEN PRAIRIE, MN 55346

I HEREBY CERTIFY THAT THIS PLAN WAS PREPARED BY ME OR UNDER MY CLOSE PERSONAL SUPERVISION AND THAT I AM A DULY LICENSED PROFESSIONAL ENGINEER UNDER THE LAWS OF THE STATE OF MINNESOTA.  
*Gretchen Schroeder*  
GRETCHEN SCHROEDER  
03/03/2025; LICENSE NO. 43016

**SOUTHWEST TRANSIT PLAZA**  
CHANHASSEN, MN

**Westwood**  
17201 Winthrop Drive, Suite #300  
Minnnetonka, MN 55343  
westwoodps.com  
Phone: (822) 837-5150  
Fax: (822) 837-5822  
Toll Free: (888) 937-5150  
Westwood Professional Services, Inc.

**GRADING & EROSION CONTROL PLAN**

SHEET NUMBER:  
**C300**  
DATE: 03/03/2025  
PROJECT NUMBER: 0044293.00

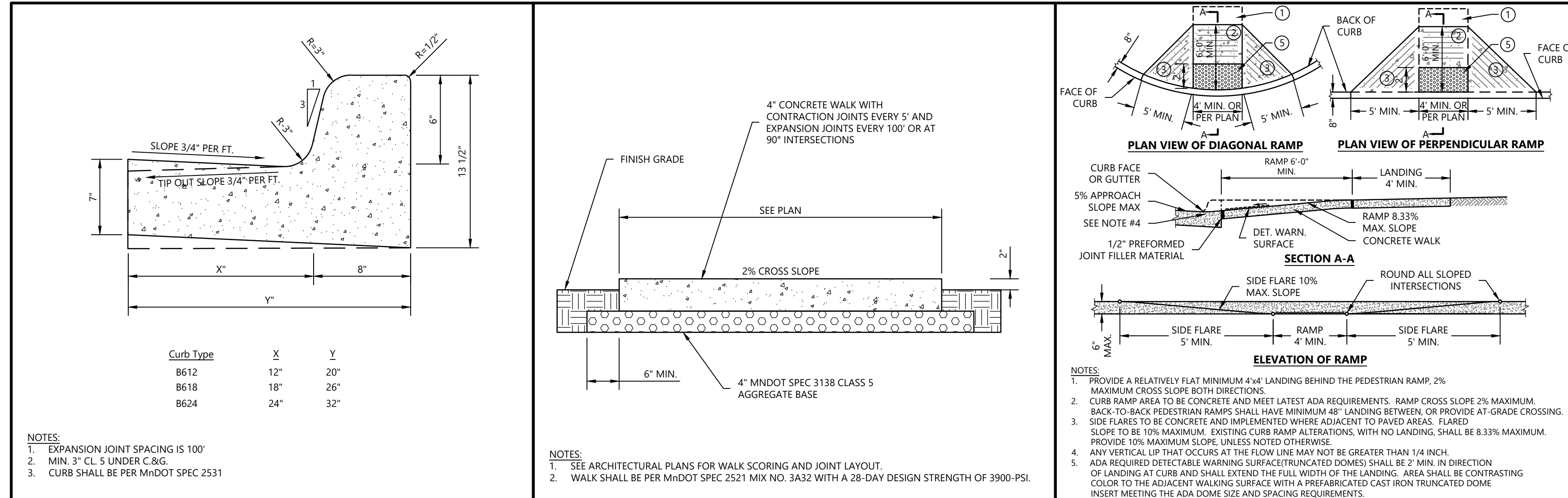

Westwood	B6 STYLE CURB AND GUTTER	LAST REVISED: 01/05/20	Westwood	PRIVATE CONCRETE SIDEWALK	LAST REVISED: 08/15/17	Westwood	PUBLIC PEDESTRIAN CURB RAMP	LAST REVISED: 08/15/17
		SI01			SI08			SI09A



Westwood	CONSTRUCTION JOINT	LAST REVISED: 06/15/17
		SI23

DESIGNED:	
CHECKED:	
DRAWN:	
HORIZONTAL SCALE#:	
VERTICAL SCALE#:	

INITIAL ISSUE: 06/09/2023  
REVISIONS: 03/03/25 PLAZA REDESIGN

PREPARED FOR:  
**SOUTHWEST TRANSIT**  
14405 WEST 62ND ST  
EDEN PRAIRIE, MN 55346

I HEREBY CERTIFY THAT THIS PLAN WAS PREPARED BY ME OR UNDER MY CLOSE PERSONAL SUPERVISION AND THAT I AM A DAILY LICENSED PROFESSIONAL ENGINEER UNDER THE LAWS OF THE STATE OF MINNESOTA

*Gretchen Schroeder*  
GRETCHEN SCHROEDER  
03/03/2025 LICENSE NO. 43016

**SOUTHWEST TRANSIT PLAZA**  
CHANHASSEN, MN

**Westwood**  
12701 Winnetka Drive, Suite #200  
Minnetonka, MN 55343  
westwoodps.com

Phone: (888) 937-5150  
Fax: (888) 937-5150  
Toll Free: (888) 937-5150  
Westwood Professional Services, Inc.

DETAILS

SHEET NUMBER:  
**C400**  
DATE: 03/03/2025  
PROJECT NUMBER: 0044293.00

ISSUED FOR BID



**PLANTING NOTES**

- CONTRACTOR SHALL CONTACT COMMON GROUND ALLIANCE AT 811 OR CALL811.COM TO VERIFY LOCATIONS OF ALL UNDERGROUND UTILITIES PRIOR TO INSTALLATION OF ANY PLANTS OR LANDSCAPE MATERIAL.
- ACTUAL LOCATION OF PLANT MATERIAL IS SUBJECT TO FIELD AND SITE CONDITIONS.
- NO PLANTING WILL BE INSTALLED UNTIL ALL GRADING AND CONSTRUCTION HAS BEEN COMPLETED IN THE IMMEDIATE AREA.
- ALL SUBSTITUTIONS MUST BE APPROVED BY THE LANDSCAPE ARCHITECT PRIOR TO SUBMISSION OF ANY BID AND/OR QUOTE BY THE LANDSCAPE CONTRACTOR.
- CONTRACTOR SHALL PROVIDE TWO YEAR GUARANTEE OF ALL PLANT MATERIALS. THE GUARANTEE BEGINS ON THE DATE OF THE LANDSCAPE ARCHITECT'S OR OWNER'S WRITTEN ACCEPTANCE OF THE INITIAL PLANTING. REPLACEMENT PLANT MATERIAL SHALL HAVE A ONE YEAR GUARANTEE COMMENCING UPON PLANTING.
- ALL PLANTS TO BE SPECIMEN GRADE, MINNESOTA-GROWN AND/OR HARDY. SPECIMEN GRADE SHALL ADHERE TO, BUT IS NOT LIMITED BY, THE FOLLOWING STANDARDS:  
ALL PLANTS SHALL BE FREE FROM DISEASE, PESTS, WOUNDS, SCARS, ETC.  
ALL PLANTS SHALL BE FREE FROM NOTICEABLE GAPS, HOLES, OR DEFORMITIES.  
ALL PLANTS SHALL BE FREE FROM BROKEN OR DEAD BRANCHES.  
ALL PLANTS SHALL HAVE HEAVY, HEALTHY BRANCHING AND LEAFING.  
CONIFEROUS TREES SHALL HAVE AN ESTABLISHED MAIN LEADER AND A HEIGHT TO WIDTH RATIO OF NO LESS THAN 5:3.
- PLANTS TO MEET AMERICAN STANDARD FOR NURSERY STOCK (ANSI Z60.1-2014 OR MOST CURRENT VERSION) REQUIREMENTS FOR SIZE AND TYPE SPECIFIED.
- PLANTS TO BE INSTALLED AS PER MNLA & ANSI STANDARD PLANTING PRACTICES.
- PLANTS SHALL BE IMMEDIATELY PLANTED UPON ARRIVAL AT SITE. PROPERLY HEEL-IN MATERIALS IF NECESSARY; TEMPORARY ONLY.
- PRIOR TO PLANTING, FIELD VERIFY THAT THE ROOT COLLAR/ROOT FLAIR IS LOCATED AT THE TOP OF THE BALLED & BURLAP TREE. IF THIS IS NOT THE CASE, SOIL SHALL BE REMOVED DOWN TO THE ROOT COLLAR/ROOT FLAIR. WHEN THE BALLED & BURLAP TREE IS PLANTED, THE ROOT COLLAR/ROOT FLAIR SHALL BE EVEN OR SLIGHTLY ABOVE FINISHED GRADE.
- OPEN TOP OF BURLAP ON BB MATERIALS; REMOVE POT ON POTTED PLANTS; SPLIT AND BREAK APART PEAT POTS.
- PRUNE PLANTS AS NECESSARY - PER STANDARD NURSERY PRACTICE AND TO CORRECT POOR BRANCHING OF EXISTING AND PROPOSED TREES.
- WRAP ALL SMOOTH-BARKED TREES - FASTEN TOP AND BOTTOM. REMOVE BY APRIL 1ST.
- STAKING OF TREES AS REQUIRED; REPOSITION, PLUMB AND STAKE IF NOT PLUMB AFTER ONE YEAR.
- THE NEED FOR SOIL AMENDMENTS SHALL BE DETERMINED UPON SITE SOIL CONDITIONS PRIOR TO PLANTING. LANDSCAPE CONTRACTOR SHALL NOTIFY LANDSCAPE ARCHITECT FOR THE NEED OF ANY SOIL AMENDMENTS.
- BACKFILL SOIL AND TOPSOIL TO ADHERE TO MN/DOT STANDARD SPECIFICATION 3877 (SELECT TOP SOIL BORROW) AND TO BE EXISTING TOP SOIL FROM SITE FREE OF ROOTS, ROCKS LARGER THAN ONE INCH, SUBSOIL DEBRIS, AND LARGE WEEDS UNLESS SPECIFIED OTHERWISE. MINIMUM 6" DEPTH TOPSOIL FOR ALL LAWN GRASS AREAS AND 12" DEPTH TOPSOIL FOR TREE, SHRUBS, AND PERENNIALS.
- MULCH TO BE AT ALL TREE, SHRUB, PERENNIAL AND MAINTENANCE AREAS. TREE AND SHRUB PLANTING BEDS SHALL HAVE 4" DEPTH OF SHREDDED HARDWOOD MULCH. SHREDDED HARDWOOD MULCH TO BE USED AROUND ALL PLANTS WITHIN TURF AREAS. PERENNIAL AND ORNAMENTAL GRASS BEDS SHALL HAVE 2" DEPTH SHREDDED HARDWOOD MULCH. MULCH TO BE FREE OF DELETERIOUS MATERIAL AND NATURAL COLORED, OR APPROVED EQUAL. MULCH TO MATCH EXISTING CONDITIONS (WHERE APPLICABLE).
- EDGING TO BE COMMERCIAL GRADE VALLEY-VIEW BLACK DIAMOND (OR EQUAL) POLY EDGING OR SPADED EDGE, AS INDICATED. POLY EDGING SHALL BE PLACED WITH SMOOTH CURVES AND STAKED WITH METAL SPIKES NO GREATER THAN 4 FOOT ON CENTER WITH BASE OF TOP BEAD AT GRADE. FOR MOWERS TO CUT ABOVE WITHOUT DAMAGE. UTILIZE CURBS AND SIDEWALKS FOR EDGING WHERE POSSIBLE. EDGING TO MATCH EXISTING CONDITIONS (WHERE APPLICABLE).
- ALL DISTURBED AREAS TO BE SODDED OR SEEDDED, UNLESS OTHERWISE NOTED. SOD TO BE STANDARD MINNESOTA GROWN AND HARDY BLUEGRASS MIX, FREE OF LAWN WEEDS. ALL TOPSOIL AREAS TO BE RAKED TO REMOVE DEBRIS AND ENSURE DRAINAGE. SLOPES OF 3:1 OR GREATER SHALL BE STAKED. SEED AS SPECIFIED AND PER MN/DOT SPECIFICATIONS. IF NOT INDICATED ON LANDSCAPE PLAN, SEE EROSION CONTROL PLAN.
- PROVIDE IRRIGATION TO ALL PLANTED AREAS ON SITE. IRRIGATION SYSTEM TO BE DESIGN/BUILD BY LANDSCAPE CONTRACTOR. LANDSCAPE CONTRACTOR TO PROVIDE SHOP DRAWINGS TO LANDSCAPE ARCHITECT FOR APPROVAL PRIOR TO INSTALLATION OF IRRIGATION SYSTEM. CONTRACTOR TO PROVIDE OPERATION MANUALS, AS-BUILT PLANS, AND NORMAL PROGRAMMING. SYSTEM SHALL BE WINTERIZED AND HAVE SPRING STARTUP DURING FIRST YEAR OF OPERATION. SYSTEM SHALL HAVE ONE-YEAR WARRANTY ON ALL PARTS AND LABOR. ALL INFORMATION ABOUT INSTALLATION AND SCHEDULING CAN BE OBTAINED FROM THE GENERAL CONTRACTOR.
- CONTRACTOR SHALL PROVIDE NECESSARY WATERING OF PLANT MATERIALS UNTIL THE PLANT IS FULLY ESTABLISHED OR IRRIGATION SYSTEM IS OPERATIONAL. OWNER WILL NOT PROVIDE WATER FOR CONTRACTOR.
- REPAIR, REPLACE, OR PROVIDE SOD/SEED AS REQUIRED FOR ANY ROADWAY BOULEVARD AREAS ADJACENT TO THE SITE DISTURBED DURING CONSTRUCTION.
- REPAIR ALL DAMAGE TO PROPERTY FROM PLANTING OPERATIONS AT NO COST TO OWNER.

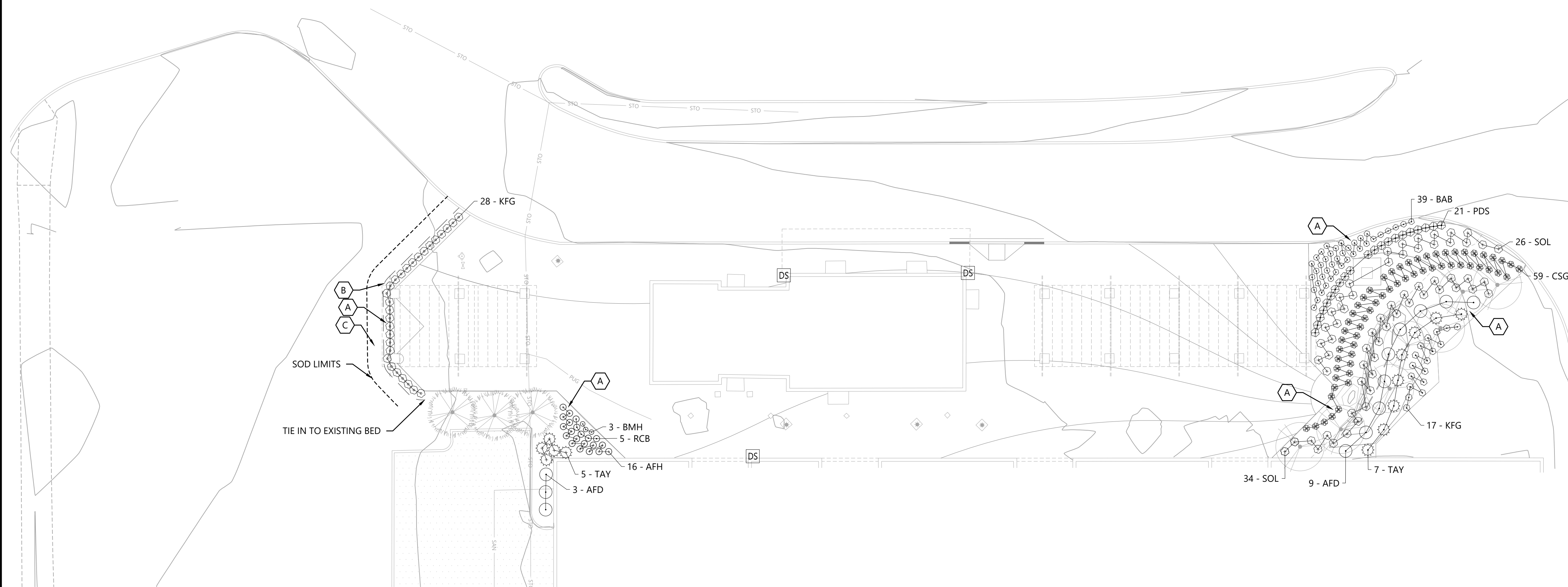

**PLANT SCHEDULE**

CODE	QTY	COMMON / BOTANICAL NAME	SIZE	SPACING O.C.
<b>CONIFEROUS SHRUBS</b>				
TAY	13	TAUNTON'S YEW / TAXUS X MEDIA 'TAUNTONII'	#5 CONT.	4'-0" O.C.
<b>DECIDUOUS SHRUB</b>				
AFD	12	ARCTIC FIRE® RED TWIG DOGWOOD / CORNUS SERICEA 'FARROW'	#5 CONT.	4'-0" O.C.
<b>PERENNIALS</b>				
RCB	5	NORTHERN EXPOSURE™ RED CORAL BELLS / HEUCHERA X 'TNHEUNER'	#1 CONT.	24" O.C.
AFH	16	SHADOWLAND AUTUMN FROST HOSTA / HOSTA X 'AUTUMN FROST'	#1 CONT.	24" O.C.
BMH	3	BLUE MOUSE EARS HOSTA / HOSTA X 'BLUE MOUSE EARS'	#1 CONT.	18" O.C.
<b>GRASSES</b>				
BAB	39	BLONDE AMBITION BLUE GRAMA / BOUTELOUA GRACILIS 'BLONDE AMBITION'	#1 CONT.	18" O.C.
KFG	45	KARL FOERSTER FEATHER REED GRASS / CALAMAGROSTIS X ACUTIFLORA 'KARL FOERSTER'	#1 CONT.	24" O.C.
CSG	59	CHEYENNE SKY SWITCH GRASS / PANICUM VIRGATUM 'CHEYENNE SKY'	#1 CONT.	24" O.C.
SOL	63	STANDING OVATION LITTLE BLUESTEM / SCHIZACHYRIUM SCOPARIUM 'STANDING OVATION'	#1 CONT.	30" O.C.
PDS	21	PRAIRIE DROPSEED / SPOROBOLUS HETEROLEPIS	#1 CONT.	24" O.C.

ABBREVIATIONS: B&B = BALLED AND BURLAPPED CAL = CALIPER HT. = HEIGHT MIN. = MINIMUM O.C. = ON CENTER QTY. = QUANTITY CONT. = CONTAINER

NOTE: QUANTITIES ON PLAN SUPERSEDE LIST QUANTITIES IN THE EVENT OF A DISCREPANCY.

**LANDSCAPE LEGEND**

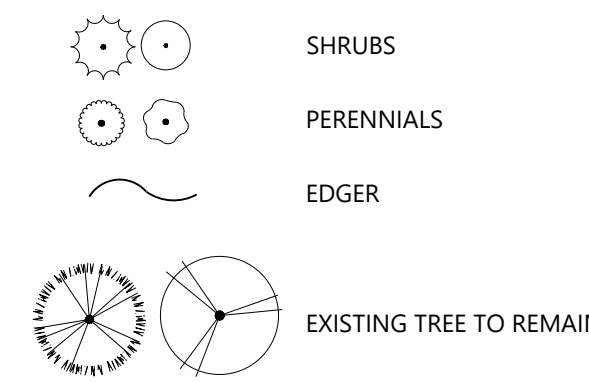

**LANDSCAPE KEYNOTES**

- A SHREDDED HARDWOOD MULCH (TYP.)
- B EDGER (TYP.)
- C SOD (TYP.)

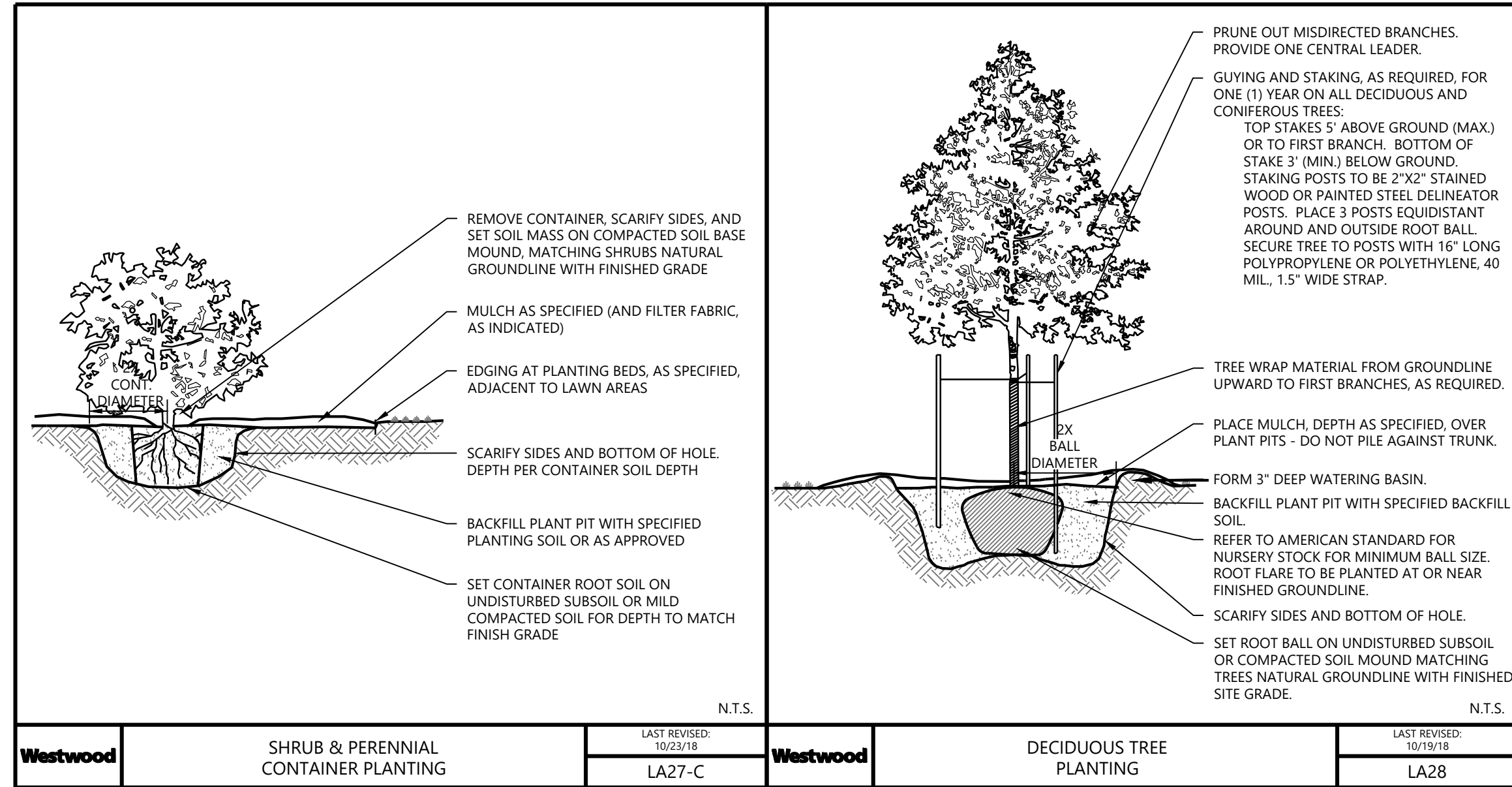

Westwood	SHRUB & PERENNIAL CONTAINER PLANTING	LAST REVISED: 10/23/18	Westwood	DECIDUOUS TREE PLANTING	LAST REVISED: 10/19/18
		LA27-C			LA28

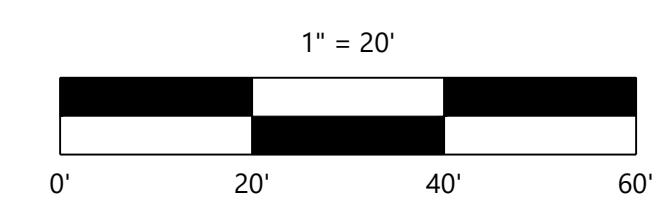

ISSUED FOR BID

DESIGNED:	
CHECKED:	
DRAWN:	
HORIZONTAL SCALE:	20'
VERTICAL SCALE:	4' @ 2"
INITIAL ISSUE:	06/09/2023
REVISIONS:	03/03/25 PLAZA REDSIGN

PREPARED FOR:  
**SOUTHWEST TRANSIT**  
14405 WEST 62ND ST  
EDEN PRAIRIE, MN 55346

I HEREBY CERTIFY THAT THIS PLAN WAS PREPARED BY ME OR UNDER MY CLOSE PERSONAL SUPERVISION AND THAT I AM A DULY LICENSED LANDSCAPE ARCHITECT UNDER THE LAWS OF THE STATE OF MINNESOTA.  
GRETCHEN SCHROEDER  
03/03/2025 LICENSE NO. 43016

**SOUTHWEST TRANSIT PLAZA**  
CHANHASSEN, MN

**Westwood**  
12701 Winnetka Drive, Suite #300  
Minnetonka, MN 55343  
westwoodps.com  
Phone: (952) 832-5150  
Fax: (952) 832-5922  
Toll Free: (888) 937-5150  
Westwood Professional Services, Inc.

**LANDSCAPE PLAN**

SHEET NUMBER:

**L100**

DATE: 03/03/2025

PROJECT NUMBER: 0044293.00